

“Ineffective and inaccurate lubrication practices are costing companies millions of dollars each year, yet it is one of the easiest cost categories to streamline and control.”

LUBRICATION PROGRAM DEVELOPMENT

Transforming a lubrication program to best practice needs to be planned, managed and well structured. Few organizations have sufficient resources or expertise to see it through.

At Noria Corporation, we do.

Our Lubrication Program Development (LPD) provides a highly detailed plan of attack to achieve lubrication excellence. Our experienced and focused team of elite lubrication engineering professionals do the leg work to deliver this turn-key solution quickly, so you can begin enjoying the cost-saving, proven reliability benefits.

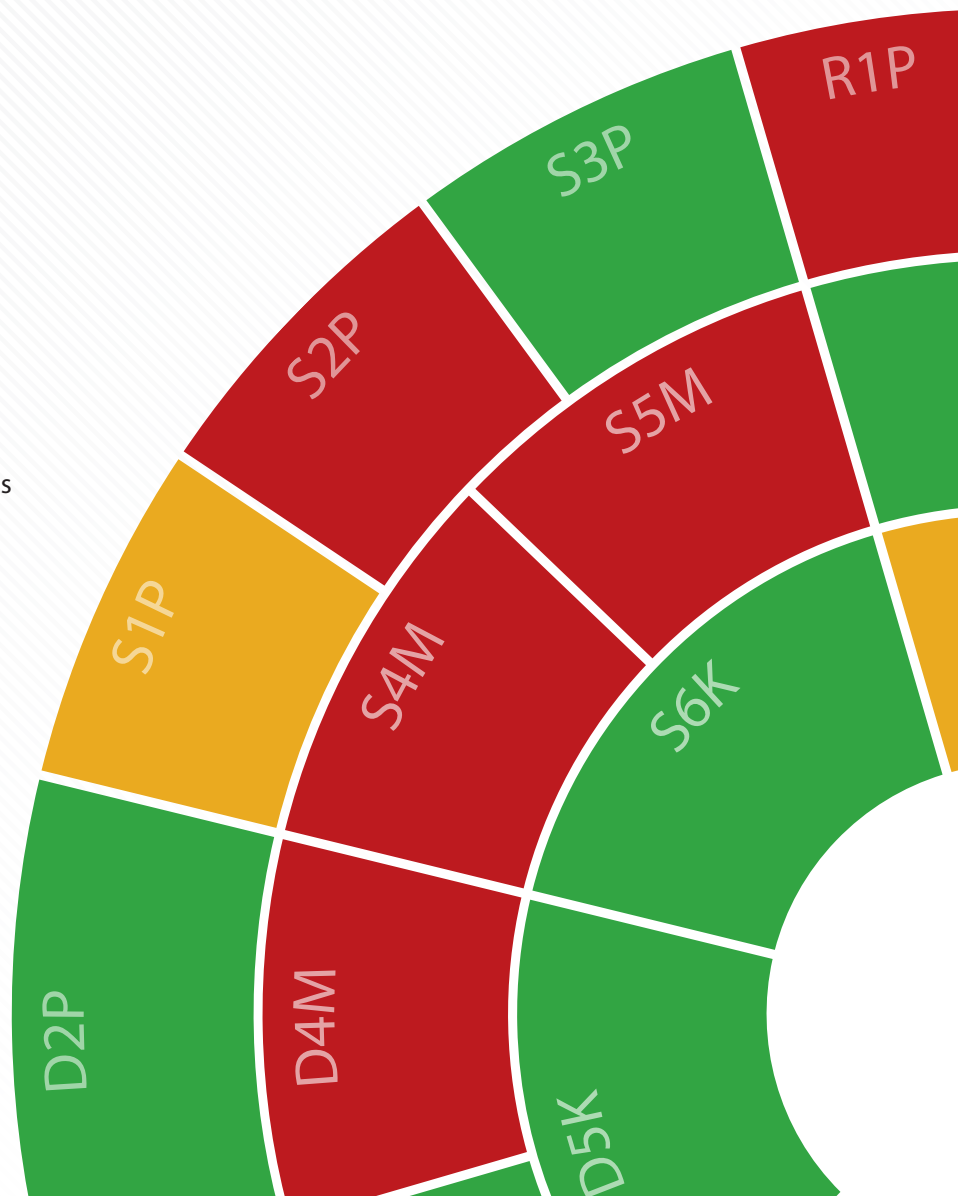

Assess



The Ascend Benchmark Assessment is a gap analysis service designed to compare current facility lubrication practices against best practice. The purpose is to design a roadmap to lubrication excellence by highlighting opportunities for improvement based on both observation of current practice and perceived opportunities.

This 600-point assessment survey provides improvement objectives and recommendations for 40 key elements of a lubrication program. This phase is a three-day process that includes: interviews with facility stakeholders, a guided facility tour of lubrication storage, handling and application in practice, off-site report development, a detailed report presentation to management and a half-day Lubrication Awareness training.

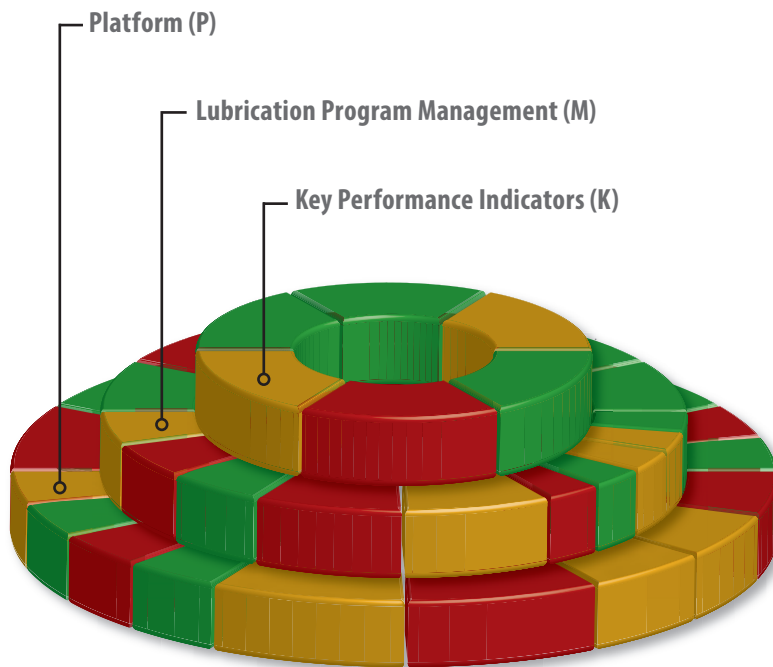
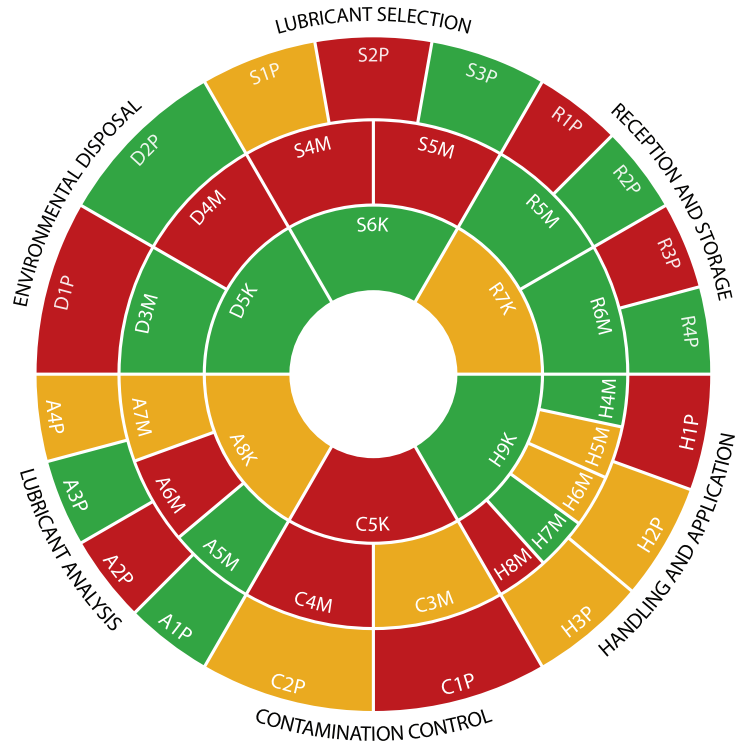

THE BENCHMARK ASSESSMENT REPORT PROVIDES:

- Executive Summary
- SWOT Analysis
- Overall Compliance Level
- Priority Next Steps
- Cost Benefit Analysis
- Assessment of 40 Elements. Each includes:
 - Current Maturity Grade
 - Current Best Practices
 - Improvement Recommendations
 - Metrics and KPI Recommendations
 - Periodic Review and Audit Recommendations

Design

Utilizing proprietary internal technology tools, Noria will survey all lubricated assets to collect information and engineer an optimized lubrication program. From this data, you will receive a complete plan to implement, run and maintain a world-class lubrication program.

DISCOVERY

- Discovery consists of a detailed walk down of each lubrication point collecting current-state data such as current lubricant, machine operating conditions, and environmental conditions.
- Data is collected with an industrial tablet device to expedite the process.
- Discovery can be done by the Noria technical team, or your lubrication team can be trained to collect the data, reducing costs and fostering project ownership.

PROCEDURES AND JOB PLANS

At the core of a lubrication program are detailed best practice procedures and work plans that help turn reactive, “firehouse” maintenance cultures into proactive and productive teams.

Noria strategically engineers every procedure with a proactive maintenance mind-set. They are designed to eliminate the root causes of machine failure, such as filling with the wrong lubricant or adding too much grease.

- Equipment hardware modifications necessary for proper contamination control, instant inspections and sampling.
- Lubrication procedures and inspections that outline the optimum lubricant, frequency, volume and cleanliness.
- PM and on-condition procedures such as oil changes, top-ups and filtration.
- Oil analysis program procedures such as sampling and test slates.

LUBRICANT STORAGE AND HANDLING DESIGN

Noria can help you design a lubricant storage and handling system that maximizes efficiency and productivity while ensuring that the correct, clean and dry lubricant is properly delivered to the equipment.

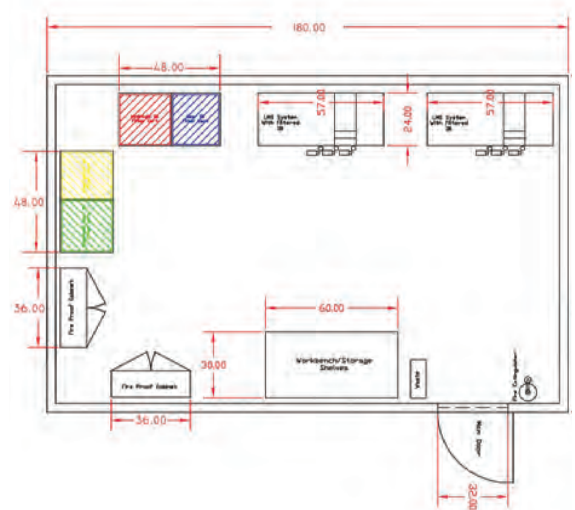

Implement

Beginning a lubrication excellence program takes planning and coordinated effort. Your Noria project manager works with you every step of the way to ensure a smooth transition from your current state to best practice.

HARDWARE SCOPING AND PROCUREMENT

Noria can assist you in selecting products for asset implementation, lubricant storage and handling and onsite laboratory equipment. We have performed extensive technical reviews of all products to assure they meet our rigorous standards of best or good practice. Detailed Noria Notes are included to educate you on any limitations or special requirements.

ENGINEERED PRODUCT CONSOLIDATION

Complete asset implementation parts lists and certain storage and handling products are derived from the Engineering Design phase. This eliminates lengthy

shopping, research, expensive over-buying, under-buying and buying products that will not perform to the levels to reach your lubrication reliability goals.

CUSTOMER SUPPORT AND PARTNERSHIP

Noria has procurement specialists dedicated solely to managing the ordering, logistics and delivery of your implementation. Ongoing complimentary email, telephone and web conference implementation support with our technical team can be provided.

VENDOR-NEUTRALITY

Vendor-neutrality simply ensures impartial, unbiased presentation of the requirements necessary for hardware implementation. Noria will never recommend one supplier's products over another's, maintaining the strictest vendor-neutral integrity. Suppliers' full product specification sheets and contact information is readily available further information is requested. Vendor-neutrality is important to Noria, to our customers and to our supplier-partners.

Sustain

While the first three phases constitute the complete LPD process, any effective reliability initiative needs to have a continuous improvement component. To sustain a successful program our customers tap into Noria's technical team on an as-needed basis to support the ongoing development of world-class lubrication practices. Such support might include general consulting or failure investigations, skills-based training and job skills assessments, or an oil analysis program development and diagnostic support.

TASK-BASED TRAINING AND ON-THE-JOB COACHING

One vitally important step to achieving sustainable change is to provide task-based training and on-the-job coaching to help plant lubrication technicians understand the importance of the newly deployed lubrication procedures. Noria's experience has shown that achieving cultural change can be difficult, which is

why it is critical to have managements' support, and a knowledgeable and motivated lubrication team. Bringing Noria's acclaimed training programs on-site can help those charged with making the new lubrication practices work understand the need for change.

MONITORING PROGRAM SUCCESS

World-class companies use oil analysis data not only to monitor equipment health, but also to provide a broader vision as to which lubrication practices are effective. The development of specific oil analysis recommendations from sample valve installation guidelines to selecting test slates is included in the design phase of the LPD. However, once samples are sent to a lab, it is equally important that the data be interpreted in the context of the plant's maintenance and reliability goals so that specific recommendations and support are provided. Noria's extensive knowledge of oil analysis enables users to gain optimum use of this condition monitoring metric.

Call to schedule a personal demonstration of the process, with real-world deliverables.